

FOR  
MAS:  
80



AREA	FORM NO.
MMA	17

Town Barnstable (Marstons Mills Center)

Address Main Street

Historic Name Methodist Church (former)

Use: Present Community Church (1981)

Original Methodist Church

DESCRIPTION:

Date before 1830

Source Trayser

Style Greek Revival with Queen Anne elements

Architect unknown

Exterior wall fabric clapboard; shingle

Outbuildings none

Major alterations (with dates) \_\_\_\_\_

belfry added c. 1890; rear ell added 1915;

side ell (Memorial Hall) added 1959

Moved from Yarmouth Date 1830

Approx. acreage under one

Setting residential village area

Photo #57-18-A17\*

86-7A-A17

86-15-A17

SKETCH MAP OVVELLS LANE

Show property's location in relation to nearest cross streets and/or geographical features. Indicate all buildings between inventoried property and nearest intersection. Indicate north.

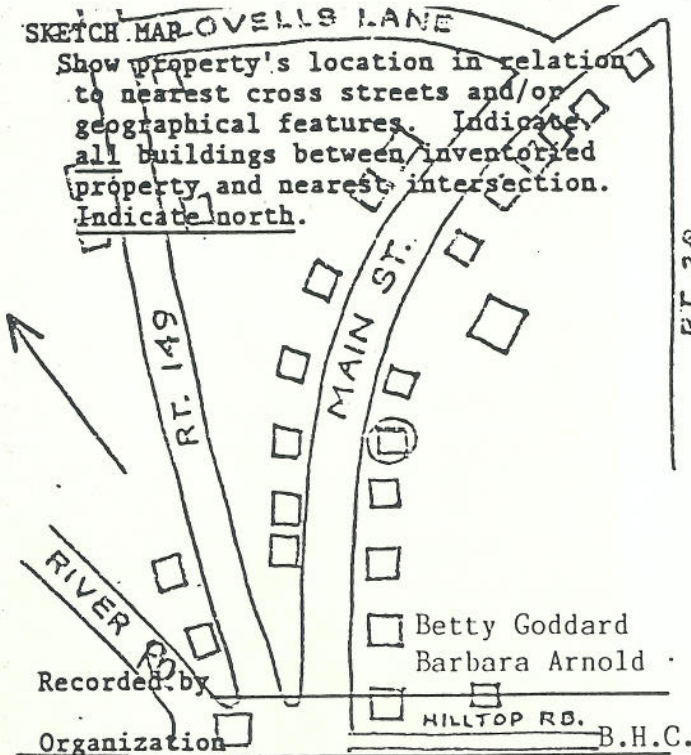

Recorded by \_\_\_\_\_

Organization \_\_\_\_\_

Date 1983

revised 1985

(Staple additional sheets here)

**ARCHITECTURAL SIGNIFICANCE** (Describe important architectural features and evaluate in terms of other buildings within the community.)

Built sometime before 1830 and brought from Yarmouth in that year, the former Methodist Church was a small simple building of rectangular plan and enclosed by a gable roof. Probably the belfry was added in 1888, but perhaps as late as 1908. It exhibits features of the Queen Anne style such as its decorative shingling and form. The belfry rises from a pedimented entry porch centered on one of the gable ends, and containing a handsome double leaf entry whose doors are panelled and also glazed with decorative Queen Anne style sash. The rear ell is a small one story structure. The side ell is also one story, but much larger extending for six bays.

**HISTORICAL SIGNIFICANCE** (Explain the role owners played in local or state history and how the building relates to the development of the community.)

The Methodist Church began to be popular on Cape Cod in the very early 19th century. "Classes" were held in private homes, including one at Hamblin Plains (Area MNC), established c. 1819. These small groups were served by circuit preachers. Soon after 1826, the Methodist Episcopal Society was formed at Marstons Mills. In 1830, a church building was moved by oxen from Yarmouth to land on Main Street given by Allan Marston and Ebenezer Scudder. Remodeling projects have occurred in 1858, 1888, 1908, and 1915, including addition of a belfry in the Queen Anne style, and of a small rear ell. In 1959 a surplus barracks from near-by Otis Airforce Base was moved to the church and added as Memorial Hall. Most of the work was done by church members. In 1964-65 a parsonage was acquired. In 1968 the Osterville and Marstons Mills churches united to form the United Methodist Church of Osterville. The parsonage was rented then sold. The church building was sold to Ruth Feeley in 1970 and used as a dance studio. In 1974 it was used as a school called "The Children's Path". Now the building is once again being used for its original purpose as the home of the Community Church, organized in 1981 with Philip Sherman as minister.

**BIBLIOGRAPHY and/or REFERENCES** (name of publication, author, date and publisher)

- Barnstable County Atlases. 1858, 1880, 1907.  
The Seven Villages of Barnstable. 1976.  
Trayser, Donald. Barnstable, Three Centuries of a Cape Cod Town. -1939.

