

FORM B - BUILDING

Massachusetts Historical Commission
80 Boylston Street
Boston, Massachusetts 02116

Assessor's number

Abuts
79-015

Burgess Park

USGS Quad

-

Area(s)

Form Number

MM A-51



Town Barnstable

Place (neighborhood or village) Marstons

Mills-South of Hamblin Pond

Address 559 Cotuit Rd. (Rte. 149)

Historic Name Burgess House a/k/a Harvey Hinckley House

Uses: Present Vacant/storage

Original Residential/Farm

Date of Construction c. 1823

Source Barnstable County Register of Deeds

Style/Form Federal Cape

Architect/Builder Unknown

Exterior Material:

Foundation Fieldstone and brick

Wall/Trim Wood shingle

Roof Wood shingle

Outbuildings/Secondary Structures Barn garage with attached apartment

Major Alterations (with dates) Moderniz (dates unknown)

Condition Fair

Moved no yes Date _____

Acreage 1.14 acre house lot

Setting Located on designated Scenic Roadway abutting Burgess Park-Town owned open space

Sketch Map

Draw a map of the area indicating properties within it. Number each property for which individual inventory forms have been completed. Label streets including route numbers, if any. Attach a separate sheet if space is not sufficient here. Indicate North.

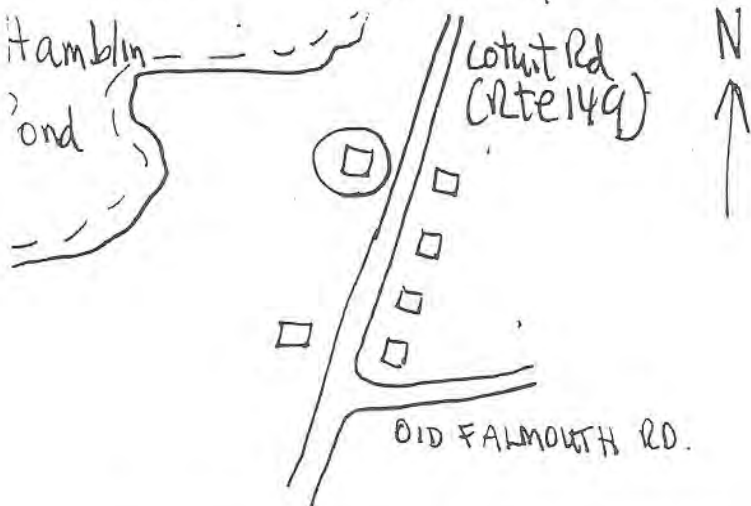

Recorded by Martin Wirtanen/Patricia

Organization Barnstable Historical Comm

Date (month/day/year) 1993/94

BUILDING FORM

MM A-51

ARCHITECTURAL DESCRIPTION see continuation sheet
Describe architectural features. Evaluate the characteristics of this building in terms of other buildings within community.

The principal structure, the Burgess House a.k.a. Harvey Hinckley House, constructed c. 1823 is an example of a Federal Cape style dwelling. The main portion of the house is one and a half story with a central chimney serving 3 fireplaces. A one story ell extends from the northerly side of the dwelling. The main portion of the dwelling is supported by a fieldstone foundation with brick foundation under the ell. Windows are typically 12/12 or 9/9. The exterior wall fabric is wood clapboard on the east and north elevations with wood shingle on the remainder. The main entrance is an enclosed portico topped by a fully pedimented gable facing the street and sided by simple pilasters.

The associated outbuilding is a one and a half-story Barn/garage with an apartment incorporated into the southerly end. The salt box style building is covered with wood shingle on both the roof and exterior walls. The portion of the building housing the apartment has a shed dormer with two windows protruding from the roof which adds space, light and ventilation to the second floor.

HISTORICAL NARRATIVE see continuation sheet
Discuss the history of the building. Explain its associations with local (or state) history. Include uses of the building and the role(s) the owners/occupants played within the community.

The property was first owned by Enoch Lovell before being set off to Jonas Whitman by an execution in 1816 who in turn sold it to Timothy (6) Hinckley, May 26, 1817. On March 30, 1792 David Parker sold Nathaniel (6) Hinckley a 20 acre parcel, southerly by the road from Barnstable to Falmouth, northerly by a pond easterly, partly by Enoch Lovell and partly by burying yard.

On April 4, 1814, Timothy (6), Asa (6), David (6), Zacheus (6) and Samuel (6) Hinckley sold all interest in the property their father Timothy (5) owned when he died, to Nathan (6) their brother. There were no probates for Timothy (5) or (6).

In 1818 Nathan (6) Hinckley sold to Timothy (6) Hinckley a 19 acre tract of land westerly by the graveyard and land of Chipman Hinckley, northwesterly by the pond, easterly by land Timothy lately bought of Jonas Whitman and southerly by the road.

In 1823 Timothy (6) Hinckley sold a seven acre tract of land to his son Harvey (7) Hinckley west by this land of Timothy, north by the Pond, easterly by other land of Timothy and former land of Samuel Goodspeed and south by the road. (see Bk. 1-165 and Bk. 4-194).

BIBLIOGRAPHY and/or REFERENCES see continuation sheet

- Barnstable County Registry of Deeds and Probate.
- Barnstable county Atlas, maps 1858 and 1880.
- Barnstable, Three Centuries of a Cape Cod Town, Donald G. Trayser, 1939.
- Sturgis Library, Genealogy records of Hinckley family.
- Attachment 1. Chain of Title, pages 1-6.

INVENTORY FORM CONTINUATION SHEET

MASSACHUSETTS HISTORICAL COMMISSION
Office of the Secretary, Boston

Community: Barnstable- Marstons Mills	Form No: MM A-51
Property Name: Harvey Hinckley a/k/a Burgess House	

Indicate each item on inventory form which is being continued below.

(Historical Narrative)

When Harvey (7) Hinckley, wife Caroline, of Nantucket sold the parcel of seven acres with house and barn in 1834 to Ezra Stephenson, physician, his name was spelled Hervey in the deed. It was bounded north by Lovell's Pond, west and east by Timothy(6) Hinckley and south by the road. Previous ownership by Enoch Lovell of this property explains its being called Lovell's Pond in this 1834 deed Bk. 17-198.

In 1835 Timothy (6) Hinckley sold onehalf of his homestead in Barnstable to Zenas (7) Hinckley, his son, on both sides of the Marstons Mills road to the West Parish Meetinghouse, Rte. 149, of 35 acres and buildings, and on December 6, 1839 sold to his sons Harvey (7) of Nantucket and Zenas (7) of Barnstable all of his real estate in Barnstable. On May 25, 1840, Harvey (7) Hinckley of Nantucket sold all his interest to Zenas (7) in the real estate which their father Timothy (6) had deeded to them in 1839.

In 1839 Ezra Stephenson, physician, sold the property of 7 acres north by Lovell's Pond with the house bounded east and west by Timothy Hinckley to Bennett Wing, physician, and in 1842 Zenas (7) Hinckley sold 6 acres of land at the southwesterly part of the homestead of Bennett Wing bounded north by the Pond, east by Bennett Wing and south by the highway.

The combined parcels are listed as 14 acres in subsequent deeds to 1907.

The pond was called the Pond, Lovell's Pond, Griegson's Pond, Grigson's Pond and on the last deed Hamblin's Pond. Another local name was Clear La

Harvey (7) Hinckley was descended from Timothy (6) (5), Benjamin (4) (3) and Samuel (2) (1). Samuel (1) Hinckley was the father of Governor Thomas (3) Hinckley (1620-1706), the sixth and last governor of Plymouth Colony. He was one of the most distinguished men in the early history of Barnstable. His father Samuel (1) first lived in Barnstable at Coggin's Pond before moving to West Barnstable by Hinckley Lane in the present 1776 Conservation area, and Hinckley's Bridge by the railroad crossing on Rte. 6A.

INVENTORY FORM CONTINUATION SHEET

MASSACHUSETTS HISTORICAL COMMISSION
Office of the Secretary, Boston

Community: Barnstable - Marstons Mills	Form No: MMA-51
Property Name: Harvey Hinckley a/a/ Burgess Hosue	

Indicate each item on inventory form which is being continued below.

ATTACHMENT !.

CHAIN OF TITLE

- 1792,
March 30
(Supporting Deed) Bk. 2-234. David Parker to Nathaniel Hinckley
A piece of land lying in Barnstable. 20 acres
Southerly by the road from Barnstable to Falmouth
Westerly by Nathaniel Hinckleys land
Northerly by a Pond
Easterly - partly by Enoch Lovell and partly by the
burying yard until it comes to the above mentioned road
- 1814
April 4
(Supporting Deed) Bk. 3-124. Timothy (6) Asa (6) David (6) Zacheus (6)
and Samuel (6) Hinckley sold all interest in the
property, land and buildings, that their honored
father Timothy (5) owned when he died to their
bother Nathan (6) Hinckley.
There were no probates for Timothy (5) or (6).
- 1817
May 26
(Supporting Deed) Bk. 3-191. Jonas Whitman to Timothery (6) Hinckley
House, barn and land that was set off to Jonas
Whitman by virtue of an execution in the year 1816.
For the bounds reference being had to the returns of
the execution of Enoch Lovell or sons estate being all
the property that I've covered by said execution
more or less.
- 1800
(Supporting Deed) Bk. 4-194. Samuel Goodspeed to Timothy Hinckley and
Asa Hinckley in equal shares
Dwelling house and 2 acres
Southeast by road from Meetinghouse in Barnstable
to Marstons Mills
N.E. by Bartlet Holmes
Northwest and Southwest by Enoch Lovells land
- (1)*
1823 Bk. 1-165. Timothy (6) Hinckley, wife Jerusha, of
Barnstable to Harvey (7) Hinckley, his son. Tract
of land 7 acres by Timothy Hinckley's house
North by Pond
South by Road
West by Timothy Hinckley
Eastby Timothy Hinckley and land he purchased from
Samuel goodspeed

Staple to Inventory form at bottom

INVENTORY FORM CONTINUATION SHEET

MASSACHUSETTS HISTORICAL COMMISSION
Office of the Secretary, Boston

Community: Barnstable Marstons ,Mills	Form No: MMA-51
Property Name: Harvey Hinckley	

a/k/a Burgess House

Indicate each item on inventory form which is being continued below.

ATTACHMENT I.

CHAIN OF TITLE

page 2

- (2)
1834
- Bk. 17-198. Hervey Hinckley, wife Caroline, of Nantucket to Ezra Stephenson, Physician House, barn and 7 acres
N. by Lovell's Pond
E. and W. by Timothy Hinckley
S. by the road
- 1835
Feb. 28
(Supporting Deed)
- Bk. 17-235. Timothy Hinckley (6) to Zenas (7) Hinckley his son
1/2 of his homestead in Barnstable .35 acres and buildings. both sides of the road leading from Marstons Mills to the West Parish Meetinghouse and 1/2 of all woodlands.
- (3)
1839
- Bk. 26-195. Ezra Stephenson, Physician, to Bennett Wing, Physician
House and 7 acres
N. by the Pond, called Lovells Pond
E. and W. by Timothy Hinckley
S. by the road
- 1839
Dec. 6
(Supporting Deed)
- Bk. 34-282. Timothy Hinckley to his sons Harvey Hinckley of Nantucket and Zenas Hinckley
All real estate Timothy owns in the Town of Barnstable. To have life time right to live on the property.
- 1840
May 25
(Supporting Deed)
- Bk. 33-550. Harvey Hinckley, wife Caroline, of Nantucket to his brother Zenas
All interest in the Real estate which their father Timothy deeded to him and Zenas.
- (4)
1842
March 24
- Bk. 29-505. Zenas Hinckley to Bennett Wing, Physician
Land at the southwesterly part of the homestead of Bennett Wing
6 Acres
N. to the Pond
E. by the Pond to Bennett Wing
S. by Bennett Wing to the highway

Staple to Inventory form at bottom

INVENTORY FORM CONTINUATION SHEET

MASSACHUSETTS HISTORICAL COMMISSION
Office of the Secretary, Boston

Community: Barnstable Marstons Mills	Form No: MM A-51
Property Name: Harvey Hinckley	

a/k/a Burgess House

Indicate each item on inventory form which is being continued below.

ATTACHMENT I.

CHAIN OF TITLE

page 3.

- (5)
1842
Aug. 17
- Bennett Wing, Physician, will
Probate case No. 1680
Wife - Eulielma Wing and Joseph Hoxie
named executrix and executor
Empowered to sell property
Real Estate Schedule
1. House, barn and othe outbuildings
2. Woodshed
- (6)
1843
- Bk. 31-482. Eulielma Wing and Joseph Hoxie
Executors of the Bennett Wing will to
Benjamin F. Scudder
Homestead and buildings 14 acres in Barnstable
Southerly by road from Marstons Mills to the
Northwest Parish meeting house in Barnstble
Westerly by Zenas Hinckley
Northerly by a pond
Easterly by Zenas Hinckley
- (7)
1876
- Benjamin F. Scudder. All Real estate to Maria F.
Scudder
Probate Case No. 6970
- (8)
1885
- Maria Scudder. Incompetent - Guardian Cyrenius A.
Lovell
Probate Case No. 8770
- (9)
1885
- Benjamin F. Scudder (See Copy)
Probate Case No. 8818
Lic. to sell homestead by public auction by
Horace L. Lovell, Trustee
- (10)
1885
- Bk. 166-403. Auction to Jacob Lovell
Bldgs. and 14 acres by a Pond
- (11)
1885
- Bk. 172-12. Jacob Lovell to Abner F. Crosby
Bldgs and 14 acres by a Pond
- (12)
1897
- Bk. 227-263. Addie G. Crosby, wife of Late Abner f.
Crosbyto Wilton B. Cammett
Bldgs and 14 acres by a Pond

Staple to Inventory form at bottom

INVENTORY FORM CONTINUATION SHEET

MASSACHUSETTS HISTORICAL COMMISSION
Office of the Secretary, Boston

Community: Barnstable Marstons Mills	Form No: MM A-51
Property Name: Harvey Hinckley	

Indicate each item on inventory form which is being continued below. ^{a/k/a Burgess House}

ATTACHMENT I. CHAIN OF TITLE page 4.

- (13)
1907 Bk. 282-253. Wilton B. Cammett to Charles H. Leland
Bldgs. and 14 acres
N. to a Pond sometimes known as "Grigsoms Pond"
- (14)
1907 Bk. 282-275. Bennett W. Cammett to Charles H. Leland
14 acres Land only by Grigsoms Pond
Ref. Dd. 114-207 was checked
- (15)
1914 Bk. 328-409. Charles H. LeLand to Charles F. and
Margaret Carr LeLand
Parcel 9 Bldgs and 14 acres from Wilton B. Cammett
Ref. 282.253
Parcel 10 14 acres, land only, from Bennett W. Cammett
Grigsoms Pond Ref. 282.275
- (16)
1925 Bk. 422-95. Charles F. and Margaret Carr LeLand to
Malcolm Morse under a trust . The beach and woodland,
southerly by Cotuit Lake, Grigson's Pond
Bldgs and 38.18 acres
- (17)
1927 Bk. 449-522. Malcolm W. Morse to Henry C. and Margaret
R. Bedford
38.6 acres and Bldg. Griegson's Pond
- (18)
1935 Bk. 510-299. Henry C. and Margaret R. Bedford to
Emma G. Whittemore
Bldgs and 28 acres Grigson's Pond
- (19)
1937 Bk. 532-58. Emma G. (Whittemore) Wheeler to Wilfred
Wheeler, Jr.
Bldgs and 28 acres Grigson's Pond
- (20)
1937 Bk. 535-97. Wilfred Wheeler, Jr. to Emma G. Wheeler
Bldgs and 28 acres Grigson's Pond
- (21)
1938 Bk. 544-105. Emma G. Wheeler to James A. Burgess
Bldgs and 28 acres Grigson's Pond
- (22)
1948 Bk. 692-576. James A. Burgess to Rachel L. Burgess
28 ac. land and bldgs Grigson's Pond

Staple to Inventory form at bottom

INVENTORY FORM CONTINUATION SHEET

MASSACHUSETTS HISTORICAL COMMISSION
Office of the Secretary, Boston

Community: Barnstable Marstons Mills	Form No: MM A-51
Property Name: Harvey Hinckley	

Indicate each item on inventory form which is being ^{a/k/a Burgess House} continued below.

ATTACHMENT I.

CHAIN OF TITLE

page 5.

- (23)
1950 Bk. 749-147. Mary M. MacLeod to Rachel L. Burgess
Parcel 1. 20 ac. and Bldgs Ref. 429-323 Grigson's Po
Parcel 2. 6 acres Ref. 512-315

- (24)
1989 Bk. 6825-295. Rachael L. Burgess by 1st National
Bank of Boston executors, to the Town of Barnstable
Bldgs and 29.33 acres. Plan 46/6/00
by Hamblin's Pond. Formerly known as Grigson's Pond

Staple to Inventory form at bottom