

FORM B – BUILDING

MASSACHUSETTS HISTORICAL COMMISSION
MASSACHUSETTS ARCHIVES BUILDING
220 MORRISSEY BOULEVARD
BOSTON, MASSACHUSETTS 02125

Assessor's Number USGS Quad Area(s) Form Number

126016	Sandwich	E	60
--------	----------	---	----

Town: Barnstable

Place: (*neighborhood or village*) Marstons Mills

Photograph



Address: 1315 Osterville-West Barnstable Road

Historic Name: Nickolas Souza House

Uses: Present: Single family residence

Original: Single family residence

Date of Construction: 1907

Source: Barnstable deed 286/397

Style/Form: Vernacular

Architect/Builder: Unknown

Exterior Material:

Foundation: Poured concrete with large rocks

Wall/Trim: Cedar shingle

Roof: Composition shingle

Outbuildings/Secondary Structures:

None

Major Alterations (*with dates*):

Two story wing west before 1920 (?); one story wing north after 1945; small entryway west; windows replaced 1997.

Condition: Considerably altered

Moved: no | X | yes || **Date** _____

Acreage: 1.1 acres

Setting: Suburban, on corner of busy crossroads, Race Lane and Osterville-West Barnstable Road; abutting unpaved right of way to Shubael Pond.

Topographic or Assessor's Map

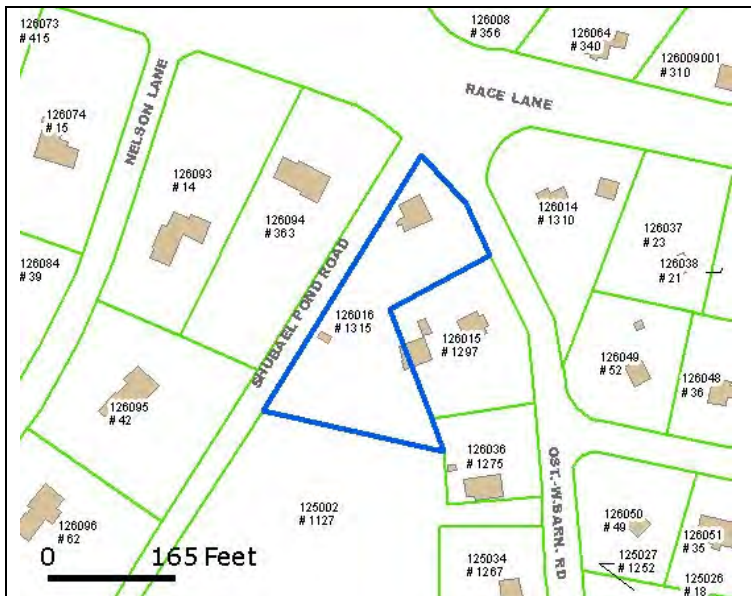

Recorded by: J. W. Gould

Organization: Marstons Mills Historical Society;
Barnstable Historical Commission

Date (*month / year*): June, 2009

INVENTORY FORM B CONTINUATION SHEET1315 OSTERVILLE-WEST BARNSTABLE ROAD
MARSTONS MILLS, BARNSTABLE

MASSACHUSETTS HISTORICAL COMMISSION

220 MORRISSEY BOULEVARD, BOSTON, MASSACHUSETTS 02125

Area(s) Form No.

E

60

 Recommended for listing in the National Register of Historic Places.*If checked, you must attach a completed National Register Criteria Statement form.**Use as much space as necessary to complete the following entries, allowing text to flow onto additional continuation sheets.***ARCHITECTURAL DESCRIPTION:**

The ground plan is L-shaped. The core is a two story wooden frame with gable end to the street, with additions west and north. The narrow 18 x 24 core is not unlike the contemporary Azorean structures in Santuit and East Falmouth. A two story gabled addition was added quite early, and a one story addition northwards. To each of these wings small enclosed entry porches have been added on the west side. A bulkhead covers step leading to the basement. The core is built upon a poured concrete foundation composed of large rocks.

HISTORICAL NARRATIVE

The house was built in 1907 for the local plumber Nickolas Souza (1868-1919) who had immigrated from the island of St. Michael in the Portuguese Azores to New Bedford about 1892 with his wife Maria Louisa (nee Rose; 1874-1939) and their children Maria Louisa and John Bettencourt (1892-1967). Three children, Edward Francis (1894-1982), Emily (1899), and Manuel (1903) were born in New Bedford. Nickolas probably worked for their plumber neighbor Frank Lapham. In 1907 he bought one acre of land on which he was to build a barn, part of Wesley Cammett's (1833-1914) 65 ½ acre "Plains Field" that had belonged to Winslow Marston in 1808.

After Nickolas's death in 1919 the house was inherited by his eldest son John Bettencourt Souza (1892-1967), a caretaker of an Osterville estate. In 1926 he sold it to his neighbor Frank T. Lapham, the plumber. The Sandwich bank foreclosed on Lapham in 1930, but was unable to sell it until 1939, to Joseph B. Mello and his wife Lydia E. (Soares). They are no known relation to the Souza's eldest daughter who married William DeMello of New York City. Lydia died in 1953, and Joseph moved to California and sold the house in 1989 for \$108,500 to Douglas W. Horton.

The Hortons were killed in 1994 when a drunken driver struck their car on Route 3 in Plymouth. The surviving son Oliver Horton sold the house in 1994 for \$89,000 to the current owners Sandra J. (b. 1964) and James¹² Harold Gifford, born 1959 son of Ronald¹¹, Harold¹⁰, Lorenzo⁹, William⁸, Edward⁷⁻⁶, Joseph⁵⁻⁴, Gershom³, William²⁻¹). Sandy is coordinator of buses for Barnstable schools. He is a carpenter who has made several alterations to the house.

BIBLIOGRAPHY and/or REFERENCES

Barnstable County Registry of Deeds, Deeds 19/131, 55/437, 56/418, 75/526, 84/490, 286/297, 312/512, 363/123, 369/375, 437/462, 456/462, 477/38, 551/471, 9342/48-50, 9898/113, 10103/341; Plan 53/35.
 Chart of Descendants of Nickolas Souza by J. W. Gould, 25 June 2007.
 Chart of Gifford Family of Marstons Mills by J. W. Gould, 11 March 2006.
 Interview with owners Sandy and Jim Gifford, 21 June 2009.
 Architectural review by Robert Frazee, 27 June 2009.